

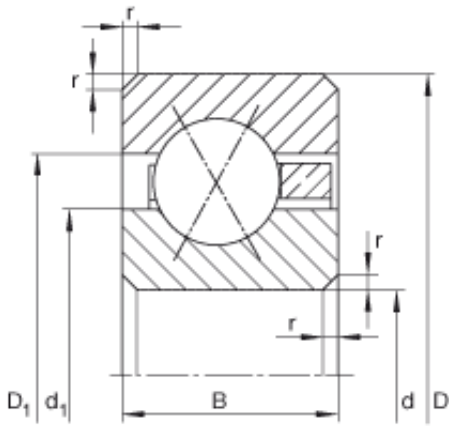

CYRE BEARING LTD

16 inch x 431,8 mm x 12,7 mm INA CSXD160 GERMANY Bearing

Bearing No. CSXD160



CSXD160 Bearing 2D drawings and 3D CAD models

Size	406.4x431.8x12.7 mm
Bore Diameter	406,4 mm
Outer Diameter	431,8 mm
Width	12,7 mm
d	406,4 mm
d	16 inch
D	431,8 mm
B	12,7 mm
D_1	422,4 mm
d_1	415,8 mm
r_{min}	1,5 mm
m	1,4 kg / Weight
C_r	26500 N / Dynamic load rating (radial)
C_{0r}	80000 N / Static load rating (radial)